

## OPTITOYOTA6-V8

Toyota speaker upgrade kit



### SPECIFICATION

Configuration	2-way component
Speaker Size	6.5" (165mm)
Peak/RMS Power	270W/90W
Sensitivity	94dB
Frequency Response	54Hz - 25kHz
Impedance	4Ω
Mounting Depth	2.4" (61mm)
Mounting Diameter	5.6" (142mm)
Recommended Amp	POWERBOX65.4M-V7

**OPTISOUND**  
VEHICLE SPECIFIC AUDIO UPGRADES  
High Efficiency OEM Speaker System

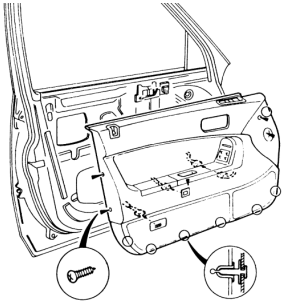

- Remove vehicle door card carefully, please ensure that all screws and clips are correctly removed and retained
- It is recommended that a set of good quality plastic trim removal tools are used in order to prevent damage to the door card that can be caused by using improper tools such as a large flat head screwdriver.
- Recommended VIBE trim removal set CLTRT-V7. Contact your authorised VIBE for more information.

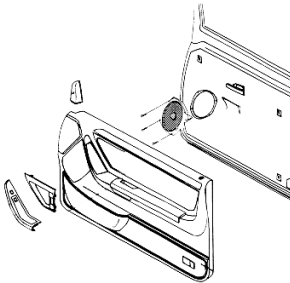

- Unplug factory speaker cabling.
- remove factory speaker and housing from door / door card making sure to retain all fixing hardware.
- **Note :** It may be necessary to drill out rivets in order to remove the factory speaker, please take care when using power tools so as not to damage the vehicle and ensure protective eyewear is worn.

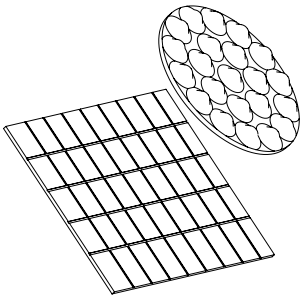

- Apply the Anti-Vibe sound deadening material to the outer door skin directly behind where the speaker is to be mounted.
- Please ensure that the area is clean and free from grease before application and applied with a hard roller and heatgun / hair drier in order to achieve the best adhesion.
- Recommended VIBE dampening roller CLDR-V7. Contact your authorised VIBE for more information.
- Apply the disc of VIBE wave diffuser over the top of the sound deadening material.

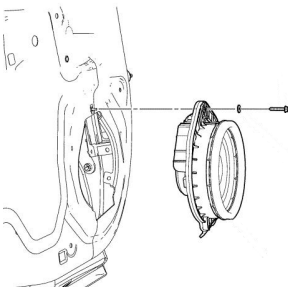

- Attach the vehicle specific adaptor ring to the door / door card.
- Note :** No screws or fixings are supplied for the adaptor ring as every vehicle will require different mounting hardware and in most cases will require the factory speaker fixings to be used.

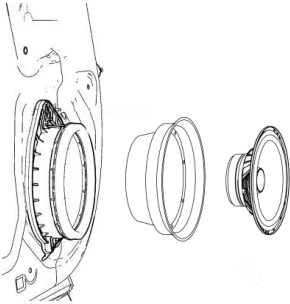

- Insert the adjustable silicone speaker baffle into the adaptor ring.
- Attach the speaker wiring loom adaptor to the vehicle speaker wiring ensuring correct polarity is observed and attach to the speaker terminals.
- Fit the OPTI6C speaker into the silicone speaker baffle and align the screw holes before securing with the supplied screws.

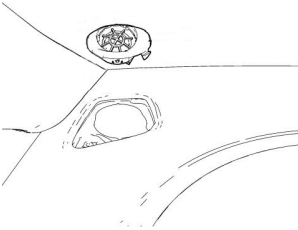

- Install the tweeter into a suitable location in the vehicle, in most cases the location of the factory installed tweeter can be utilised.
- **Note :** Methods of fitting the tweeter will vary from vehicle to vehicle and may require the tweeter to be hot glued into place.

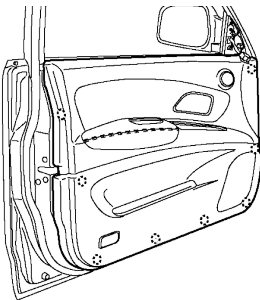

- Refit the vehicle door card.

### Tools required

- Screwdrivers
- Torx drivers
- Battery drill driver
- Safety glasses
- Trim removal tools
- Heat gun / hair drier
- Dampening roller
- Screws / bolts / fixings for speaker adaptor ring and tweeter.
- Hot glue gun (optional)



## FITMENT GUIDE

MAKE	MODEL	YEAR RANGE FROM / TO
Toyota	Corolla	2002-2007
Toyota	Yaris	2007-2012
Toyota	Sienna	1998-2012
Toyota	Matrix	2002-2011
Toyota	Rav 4	2008>
Toyota	Prius	2001-2012
Toyota	Avensis	2005>
Toyota	Auris	2007>
Toyota	Yaris Verso	2003>2005
Toyota	Avalon	2005-2014
Toyota	FJ-Cruiser	2007-2014
Toyota	Highlander	2008-2014
Toyota	Prius	2010-2014
Toyota	Sequoia	2008-2014
Toyota	Solara	2004-2009
Toyota	Tacoma	2005-2014
Toyota	Venza	2009-2014
Toyota	Tundra	2007-2014
Toyota	Camry	2002-2011
Toyota	Landcruiser	2008-2014

All VIBE products carry a full 12 month warranty, valid from the date of the original receipt and proof of purchase (UK only). The online warranty card should be completed within seven days of the original purchase date. The original receipt and packaging should be retained for this twelve month period. If the product develops a problem at any stage during the warranty period, it should be returned to the point of purchase in its original packaging, and complete with no items missing.

A full description of VIBE's warranty information can be found on our website:

[www.vibeaudio.co.uk](http://www.vibeaudio.co.uk)

### What Is Not Covered

- Damage to product due to improper installation.
- Subsequent damage to other components.
- Damage caused by exposure to moisture, excessive heat, chemical cleaners and / or UV radiation.
- Damage through negligence, misuse, accident or abuse. Repeated returns for the same fault may be considered abuse.
- Any cost or expense related to the removal and / or re-installation of the product.
- Damage caused by amplifier clipping or distortion.
- Items repaired or modified by any unauthorised repair facility.
- Return shipping on non defective items.
- Products returned without a returns authorisation number.
- Damage to product due to use of sealant.

### International Warranty

Contact your international VIBE dealer or distributor concerning specific procedure for your country's warranty policies. [www.vibeaudio.co.uk](http://www.vibeaudio.co.uk)

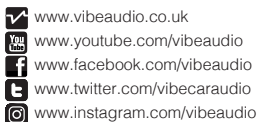

[www.vibeaudio.co.uk](http://www.vibeaudio.co.uk)

[www.youtube.com/vibeaudio](http://www.youtube.com/vibeaudio)

[www.facebook.com/vibeaudio](http://www.facebook.com/vibeaudio)

[www.twitter.com/vibecaraudio](http://www.twitter.com/vibecaraudio)

[www.instagram.com/vibeaudio](http://www.instagram.com/vibeaudio)